

# FILLER

## SUPERLIGHT, ELASTIC REPAIR AND FINISHING

### PLASTER

Ready to use

Indoors and outdoors

Keeps for a long time, even after having been open frequently

Easy to process



## GENERAL INFORMATION

### Product description

- Snow-white, superlight, elastic repair and finishing plaster
- Ready to use indoors and outdoors
- Easy to use paste
- Grain-free structure:
  - easy to spread smoothly
  - super fine result
  - cuts down on sanding
- Excellent bond on all porous constructions materials.
- Water-resistant and can be quickly painted over.
- Handles shrinkage and expansion without tearing.
- Keeps for a long time, even after having been open frequently

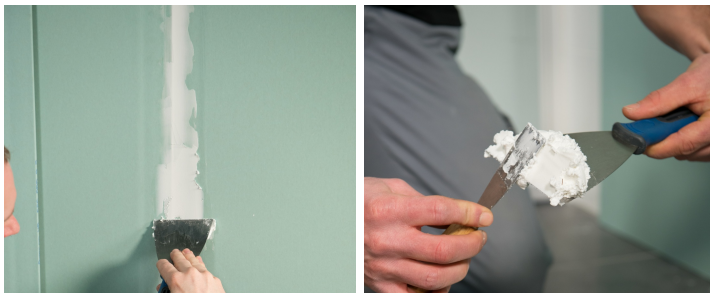

**Available packages & colors**

SKU	EAN	Description
601025296	5414195022962	Filler - jar 250ml
601075296	5414195072967	Filler - jar 750ml
601106296	5414195106297	Filler - cartridge 300ml

**Application**

For filling holes, tears and joints in walls and ceilings, plaster and stucco, plasterboard, gypsum board and blocks, wood, soft board and hard board, stone, limestone, porous concrete and all porous construction materials.

For professional repairs of damages on painted or plastered surfaces.

Can be painted over quickly.

Filler is the perfect preparation and ensure a smooth finish before painting, hanging or decorating walls and ceilings, woodwork, plasterboard and stucco.

Not suitable for use on surfaces such as metal or plastic.

# TECHNICAL INFORMATION

## Specifications

- Viscosity: paste.
- Density: (23 °C): 0,420 +/- 0,010 g/cm<sup>3</sup>.
- Base: Acryl dispersion.
- Hardening: shrinkage and tear-free.
- Skin formation by 23°C and 65% R.H.: < 20 min.
- Can be painted over: after 1 hour .
- Transport temperature: between -15°C and +40°C.
- Application temperature: between +5°C and +30°C.
- Temperature resistance after curing: from -20°C up to +100°C.
- Storage life (dry and between +5°C and +35°C):
  - cartridge 300ml: 30 months
  - other packages: 36 months.
- Safety measures: please consult safety data sheet.

## Technical data sheet

[fillernovatechtecv2024-07-12-13-37-30en-ie.pdf](#)

## INSTRUCTIONS

Apply Filler on a dry, dust-free and grease-free surface, free of loose paint chips, plaster, etc. To strengthen weak and/or loose surfaces, treating beforehand with Fixprimer (fixer) is recommended. To obtain quicker hardening with repairs deeper than 3 cm, build Filler up in layers.